



*Elevation B Farmhouse*



*Elevation A*



*Elevation B*

## *The Harper*

*The Harper is a wonderfully designed master on the main plan; this home also features a guest room on the main level. The open concept kitchen and large family room are perfect for family gatherings. The flex room makes a great home office or formal dining space.*

*For all elevations, side and front entry garages vary by community.*



Note: Exterior detail and trim may vary. Rendering is an artistic interpretation and may not be exact.

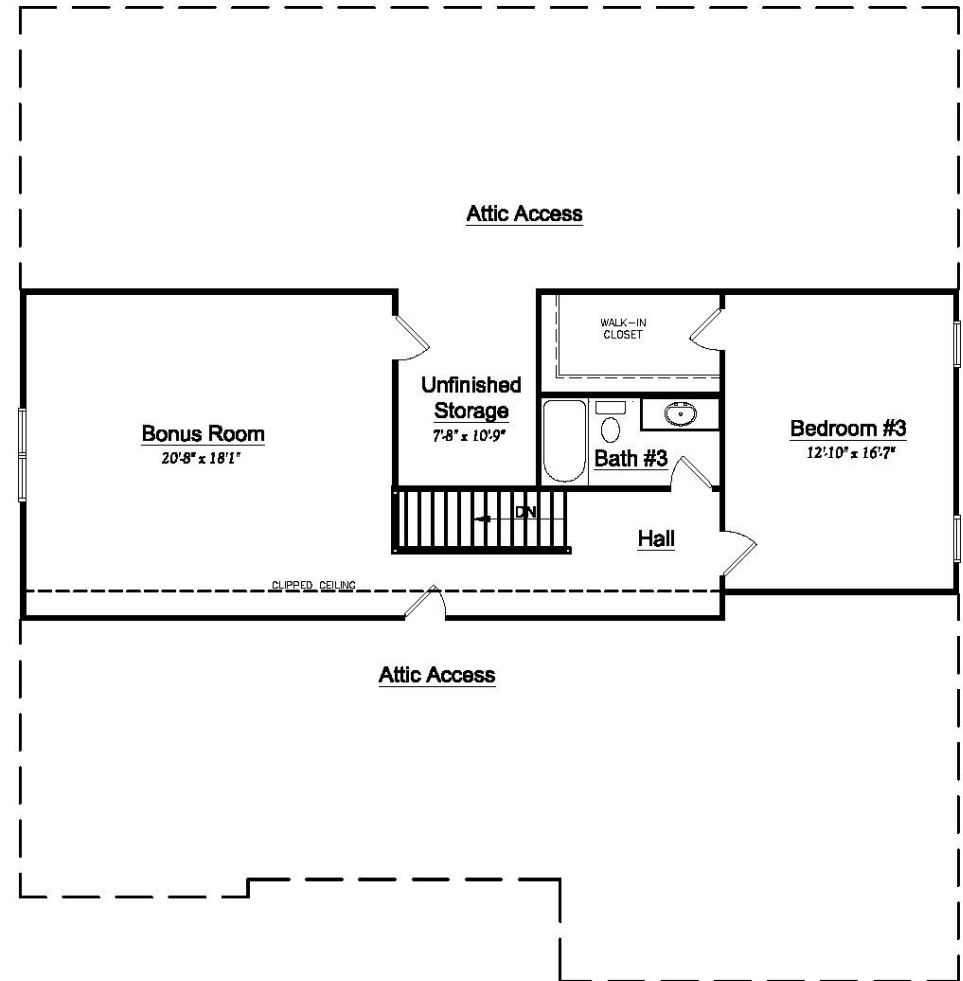

## The Harper

*This three bedroom home is perfect for families and empty nesters. The second floor features a private bedroom and spacious bonus room. The large master suite with its elegant bath and large closet on the main level are sure to please. Don't miss the guest suite on the main level.*



Note: Exterior detail and trim may vary. Rendering is an artistic interpretation and may not be exact.

[www.niblockhomes.com](http://www.niblockhomes.com)

niblock  
homes